

UP-G75-12



Specification		
Nominal Voltage	12V	
Nominal Capacity (20HR)	75.0AH	
Dimension	Length	259±3mm (10.2 inches)
	Width	168±2mm (6.61 inches)
	Container Height	208±3mm (8.19 inches)
	Total Height (with Terminal)	214±3mm (8.43 inches)
Approx Weight	Approx 23.0 kg (50.7lbs)	
Terminal	T6 / T14	
Container Material	ABS	
Rated Capacity	75.0 AH/3.75A	(20hr, 1.80V/cell, 25°C/77°F)
	69.8 AH/6.98A	(10hr, 1.75V/cell, 25°C/77°F)
	60.0 AH/12A	(5hr, 1.75V/cell, 25°C/77°F)
	52 AH/17.36A	(3hr, 1.75V/cell, 25°C/77°F)
	41.25 AH/41.25A	(1hr, 1.67V/cell, 25°C/77°F)
Max. Discharge Current	700A (5s)	
Internal Resistance	Approx 7.9mΩ	
Operating Temperature Range	Discharge: -20~55°C (-4~131°F)	
	Change : 0~40°C (32~104°F)	
	Storage : -20~50°C (-4~122°F)	
Nominal Operating Temperature Range	25±3°C (77±5°F)	
Cycle Use	Initial Charging Current less than 14.0A.Voltage. 14.4V~15.0V at 25°C (77°F) Temp. Coefficient -30mV/°C	
Standby Use	No limit on Initial Charging Current Voltage. 13.5V~13.8V at 25°C (77°F) Temp. Coefficient -20mV/°C	
Capacity affected by Temperature	40°C (104°F) 103% 25°C (77°F) 100% 0°C (32°F) 86%	
Self Discharge	Batteries may be stored for up to 9 months at 25°C (77°F) and then a freshening charge is required.	

Constant Current Discharge (Amperes) at 25°C (77°F)

F.V/Time	20min	30min	45min	1h	2h	3h	4h	5h	6h	7h	8h	9h	10h	20h
1.85V/cell	6.343	4.982	3.804	3.182	2.014	1.543	1.275	1.104	949	84	758	692	655	36
1.80V/cell	7.264	5.561	4.189	3.514	2.186	165	135	1.157	996	88	794	729	684	375
1.75V/cell	8.164	6.118	4.532	3.761	2.314	1.736	1.414	12,00	1.032	911	82	75	698	383
1.70V/cell	8.796	6.557	4.811	3.975	2.454	1.811	1.457	1.243	1.067	941	844	77	714	388
1.67V/cell	9.161	6.814	4.982	4.125	2.518	1.875	15,00	1.264	1.082	955	857	78	722	391
1.60V/cell	9.921	7.286	5.346	4.382	2.614	195	1.554	1.307	1.114	975	872	797	736	396

Constant Power Discharge (Watts/cell) at 25°C (77°F)

F.V/Time	20min	30min	45min	1h	2h	3h	4h	5h	6h	7h	8h	9h	10h	20h
1.85V/cell	12.139	96,00	7.371	6.193	3.943	3.011	2.507	2.175	1.875	1.671	1.511	1.382	1.307	719
1.80V/cell	13.725	10.629	8.068	6.804	4.243	3.214	2.646	2.271	1.971	1.736	1.575	1.446	1.361	748
1.75V/cell	15.257	11.571	8.657	7.243	4.489	3.386	2.764	2.357	2.036	18,00	1.618	1.489	1.382	762
1.70V/cell	16.254	12.289	9.129	7.618	4.736	3.525	285	2.421	21,00	1.854	1.671	1.532	1.414	77
1.67V/cell	16.736	12.632	9.386	7.854	4.832	3.621	2.904	2.464	2.121	1.875	1.693	1.543	1.436	777
1.60V/cell	17.925	13.404	10.007	8.304	5.004	3.739	3.011	2.529	2.164	1.907	1.714	1.575	1.457	788



UP-G75-12

Dimensions

■ T6 Terminal
Unit: mm [Inches]

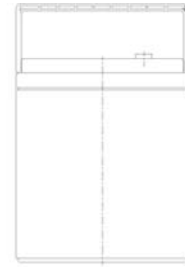
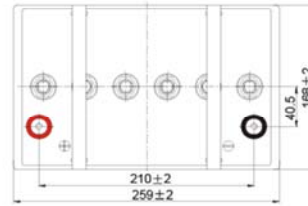
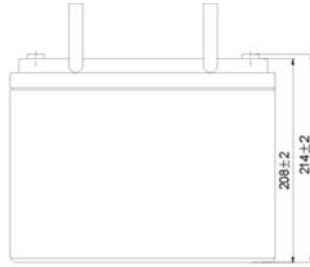
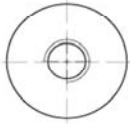
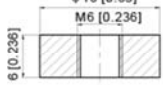

Discharge Characteristics

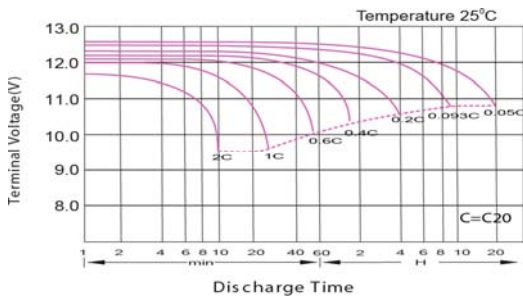

Effect of Temperature on Long Term Float Life

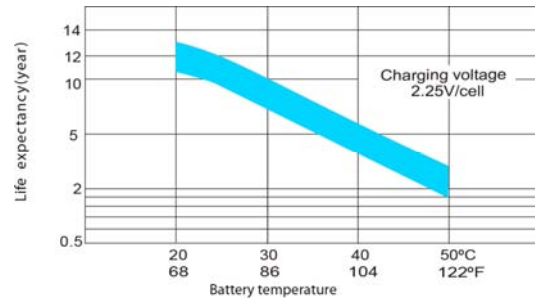

Float Charging Characteristics

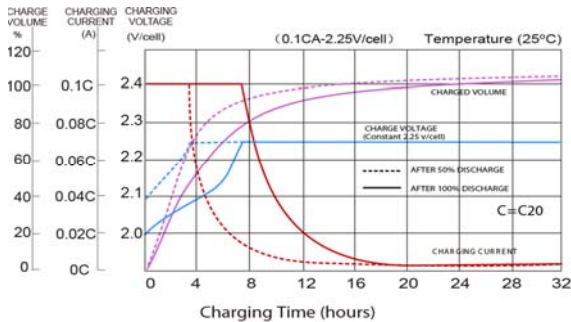

Cycle Life in Relation to Depth of Discharge

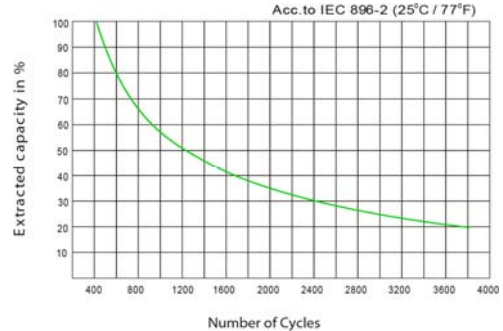

Temperature Effects in Relation to Battery Capacity

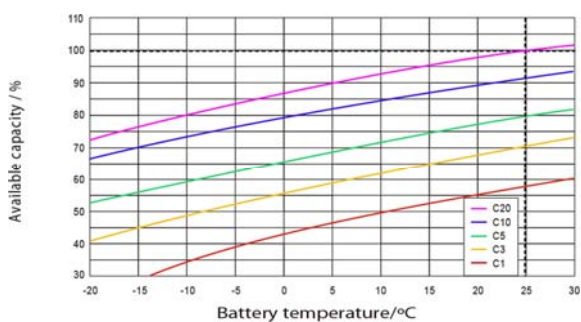

General Relation of Capacity VS. Storage Time

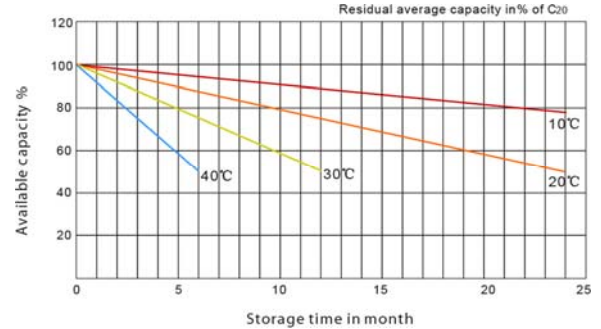

MH26866



ETL SEMKO

