

## UP-SG65-2



Specification		
Nominal Voltage	2V	
Nominal Capacity (20HR)	65.0AH	
Dimension	Length	170±2mm (6.69 inches)
	Width	72±1mm (2.83 inches)
	Container Height	205±3mm (8.07 inches)
	Total Height (with Terminal)	212±3mm (8.35 inches)
	Approx Weight	Approx 5.2kg (11.47lbs)
Terminal	T6	
Container Material	ABS	
Rated Capacity	65.0AH/3.25A	(20hr, 1.80V/cell, 25°C/77°F)
	60.0AH/6.00A	(10hr, 1.75V/cell, 25°C/77°F)
	51.6AH/10.3A	(5hr, 1.75V/cell, 25°C/77°F)
	45.9AH/15.3A	(3hr, 1.75V/cell, 25°C/77°F)
	35.2AH/35.2A	(1hr, 1.67V/cell, 25°C/77°F)
Max. Discharge Current	455A (5s)	
Internal Resistance	Approx 2.16mΩ	
Operating Temperature Range	Discharge: -20~55°C (-4~131°F)	
	Charge : 0~40°C (32~104°F)	
	Storage : -20~50°C (-4~122°F)	
Nominal Operating Temperature Range	25±3°C (77±5°F)	
Cycle Use	Initial Charging Current less than 13.0A.Voltage. 2.4V~2.5V at 25°C(77°F)Temp. Coefficient -5mV/°C	
Standby Use	No limit on Initial Charging Current Voltage. 2.25V~2.3V at 25°C(77°F)Temp. Coefficient -3mV/°C	
Capacity affected by Temperature	40°C (104°F) 103%	
	25°C (77°F) 100%	
	0°C (32°F) 86%	
Self Discharge	Batteries may be stored for up to 9 months at 25°C (77°F) and then a freshening charge is required.	

Constant Current Discharge (Amperes) at 25°C (77°F)														
F.V/Time	20min	30min	45min	1h	2h	3h	4h	5h	6h	7h	8h	9h	10h	20h
1.85V/cell	49.6	43.0	34.5	27.7	18.2	14.0	11.5	9.79	8.51	7.50	6.85	6.26	5.78	3.15
1.80V/cell	58.7	50.6	39.3	31.1	19.7	14.5	11.9	10.0	8.71	7.62	7.06	6.43	5.94	3.25
1.75V/cell	64.2	53.0	41.7	32.7	20.5	15.3	12.2	10.3	8.98	7.79	7.21	6.54	6.00	3.30
1.70V/cell	68.4	55.5	43.5	33.9	21.3	15.8	12.6	10.6	9.30	8.13	7.47	6.72	6.13	3.33
1.67V/cell	73.7	59.1	44.7	35.2	21.9	16.5	13.1	10.9	9.56	8.26	7.58	6.85	6.26	3.37
1.60V/cell	79.6	63.0	46.8	36.6	22.7	17.0	13.6	11.2	9.69	8.38	7.67	7.00	6.40	3.41

Constant Power Discharge (Watts) at 25°C (77°F)														
F.V/Time	20min	30min	45min	1h	2h	3h	4h	5h	6h	7h	8h	9h	10h	20h
1.85V/cell	93.0	81.8	66.3	53.7	35.2	27.1	22.4	19.2	16.7	14.8	13.5	12.4	11.4	6.25
1.80V/cell	108.8	94.7	74.6	59.7	38.1	28.1	23.2	19.6	17.1	15.0	13.9	12.7	11.7	6.43
1.75V/cell	118.0	98.5	78.8	62.5	39.4	29.6	23.6	20.1	17.5	15.3	14.2	12.9	11.8	6.51
1.70V/cell	125.0	102.6	81.9	64.6	40.8	30.4	24.3	20.6	18.1	15.9	14.7	13.2	12.1	6.58
1.67V/cell	133.5	108.4	83.4	66.5	41.8	31.7	25.3	21.1	18.6	16.1	14.8	13.4	12.3	6.64
1.60V/cell	142.6	114.9	86.8	68.8	43.0	32.5	26.1	21.5	18.8	16.3	15.0	13.7	12.6	6.71



**UP-SG65-2**

**Dimensions**

■ T6 Terminal  
Unit: mm [inches]

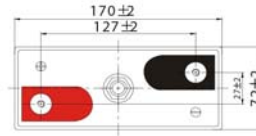
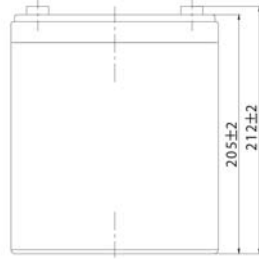
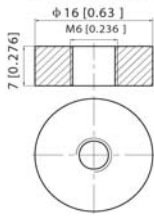

**Discharge Characteristics**

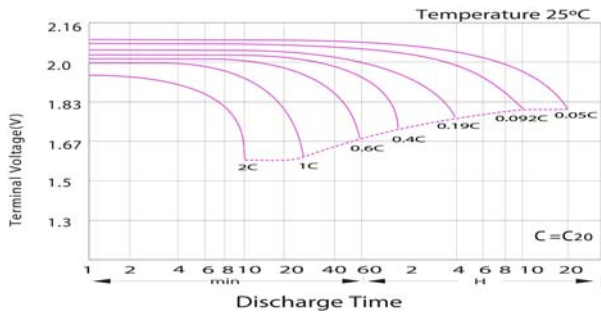

**Effect of Temperature on Long Term Float Life**

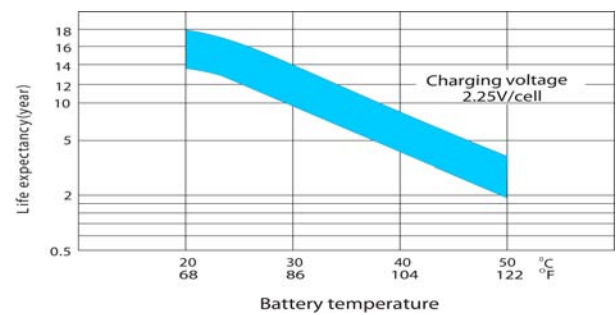

**Float Charging Characteristics**

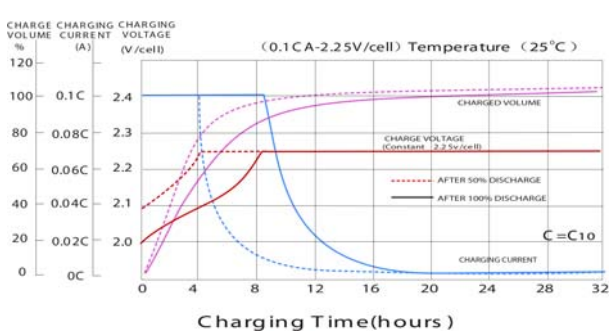

**Cycle Life in Relation to Depth of Discharge**

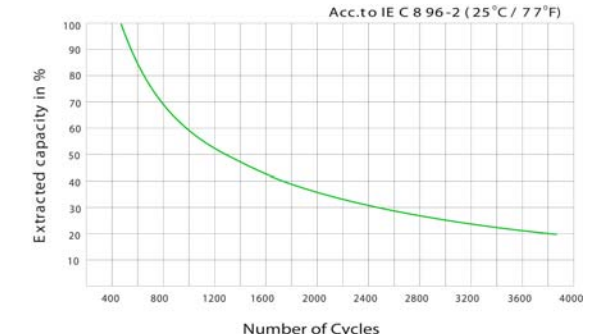

**Temperature Effects in Relation to Battery Capacity**

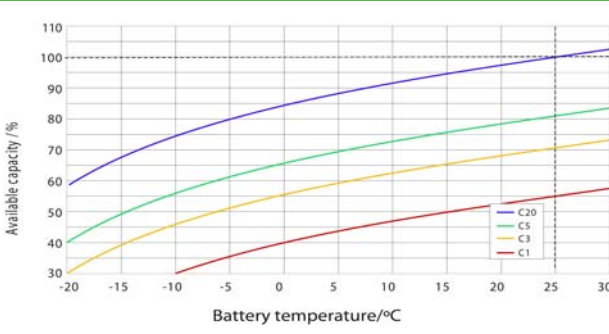

**General Relation of Capacity VS. Storage Time**

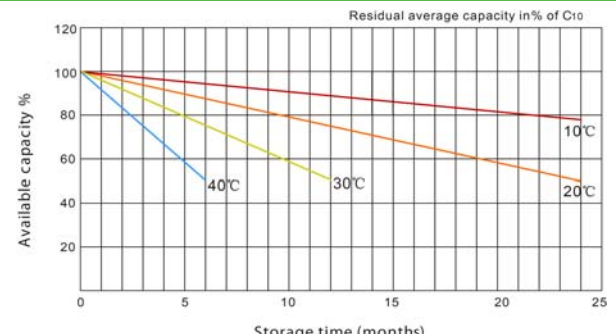

ETL SEMKO

